

CEILING

ROSE

installation

FOR DECORATING WALLS AND CEILINGS

Tools and materials



Lead pencil



Glue applicator gun
(power-actuated fastening tool)



Rubber putty knife



Protective gloves



Fine grain
abrasive paper



Cotton waste (Cloth)

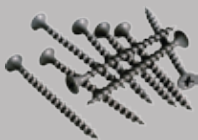

Self-tapping screw



Acetone.
White spirit



Fine grain
water-soluble filler

Adhesive



Multipurpose adhesive

Important! The following information is relevant for Evroplast «Adhesives». If you use other adhesives , follow manuals on it's package .

Work performance conditions: the temperature while performing the works and the next 24 hours must be at least + 8 ° C. Indoor relative air humidity must be 40%. Required to keep the product in the room for 24 hours at least.

Requirements to the surface: prepared surface must be dry, degreased, cleaned from dust. Weak mineral substrates should be pre-strengthened by suitable primer.

Ceiling rose installation



Drill a hole in the product.



Apply the product's outline on the ceiling.



Apply evenly on the mounting surface Assembly glue or Multipurpose glue along the whole length. The thickness of the applied adhesive should be 3-5 mm.



Attach the item to the place of installation. Push the the item along the whole circular length so the adhesive exudes from the entire plane.

FOR DECORATING WALLS AND CEILINGS

5

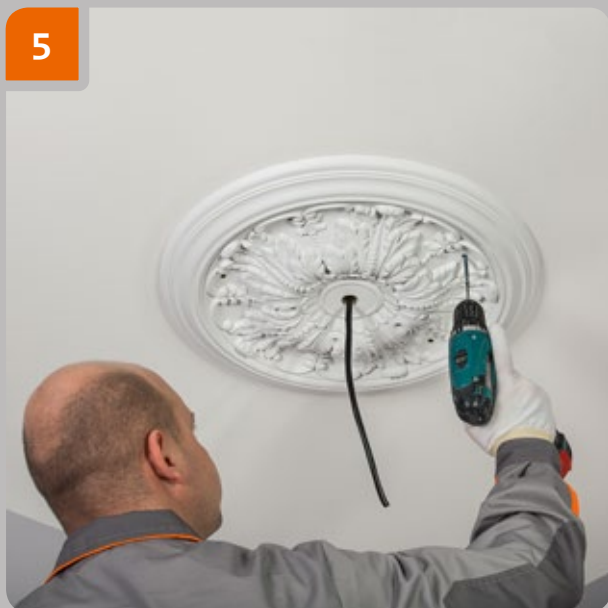

Using self-tapping screws fasten the rose to the ceiling.

6



Immediately after gluing remove the excess of glue with a spatula.

7



When using Assembly glue, remove the remaining excess of adhesive by wiping the areas with a cloth dampened with water; use acetone if Multipurpose glue is used.

8



Fill the area of screw holes with fine-grained, water-soluble filler for interior works.

CEILING ROSE INSTALLATION

9



Treat the spackling area with Fine grain abrasive paper.

10



Fill the spaces in the junction area between the cornice and the walls/ ceiling, where the adhesive has not shown on a surface.

11



Wipe the area of the junction with a wet cloth. Wet the cloth with water if Assembly glue is used and with Acetone in case of using Multipurpose glue or Glue for bonding joints.

12



Paint following the instruction of paint producer the rose and ceiling in case of need.



www.gaudidecor.eu

Gaudi
interior and facade
mouldings